



EASY ASSEMBLY AND OPERATION INSTRUCTIONS

Towering Werewolf

This item, when assembled by the following instructions, should take 15 minutes to assemble. Please follow the step by step guide and enjoy your Towering Werewolf!

WARNING

This item is not a toy and should be used for decoration only. This item contains small parts that can be a choking hazard. Keep all plastic and wire parts away from children.

1. Please use the transformer supplied by manufacturer.
2. Please assemble item according to instructions. Connect all wires according to matching color.
3. Children should be supervised by adults. Item should not be grabbed, as it becomes a tipping hazard. Keep all away from the transformer, as it heats up during operation.

CARE AND STORAGE INSTRUCTIONS

For best performance operate your item indoors. When not in use, store this product in it's original packing. Keep away from heat and moisture.

Please read all instructions carefully before assembling. Save this instruction sheet for future reference.

PARTS LIST

- A. Base
- B. Lower Support Poles x 2
- C. Right Foot
- D. Left Foot
- E. Right Middle Support pole
- F. Left Middle Support pole
- G. Right Upper Support pole
- H. Left Upper Support pole
- I. Foam Tubes x 2
- J. Pants
- K. Torso Frame
- L. Hip Hoop
- M. Shoulder Support
- N. Coat
- O. Sensor
- P. Head
- Q. Right Arm
- R. Left Arm
- S. Right Hand
- T. Left Hand
- U. Spinal Pole

AC Adapter *
 * AC Adapter Spec
 Input: 100 - 240VAC 50/60Hz
 Output: 5.9V 1.5A

BEFORE ASSEMBLING, REMOVE ALL THE ABOVE PARTS FROM BOX. IF ANY PART IS MISSING, DO NOT ATTEMPT TO ASSEMBLE THE PRODUCT AND CONTACT CUSTOMER SERVICE FROM 8:30AM TO 5:30PM PST AT 1-855-428-3921.

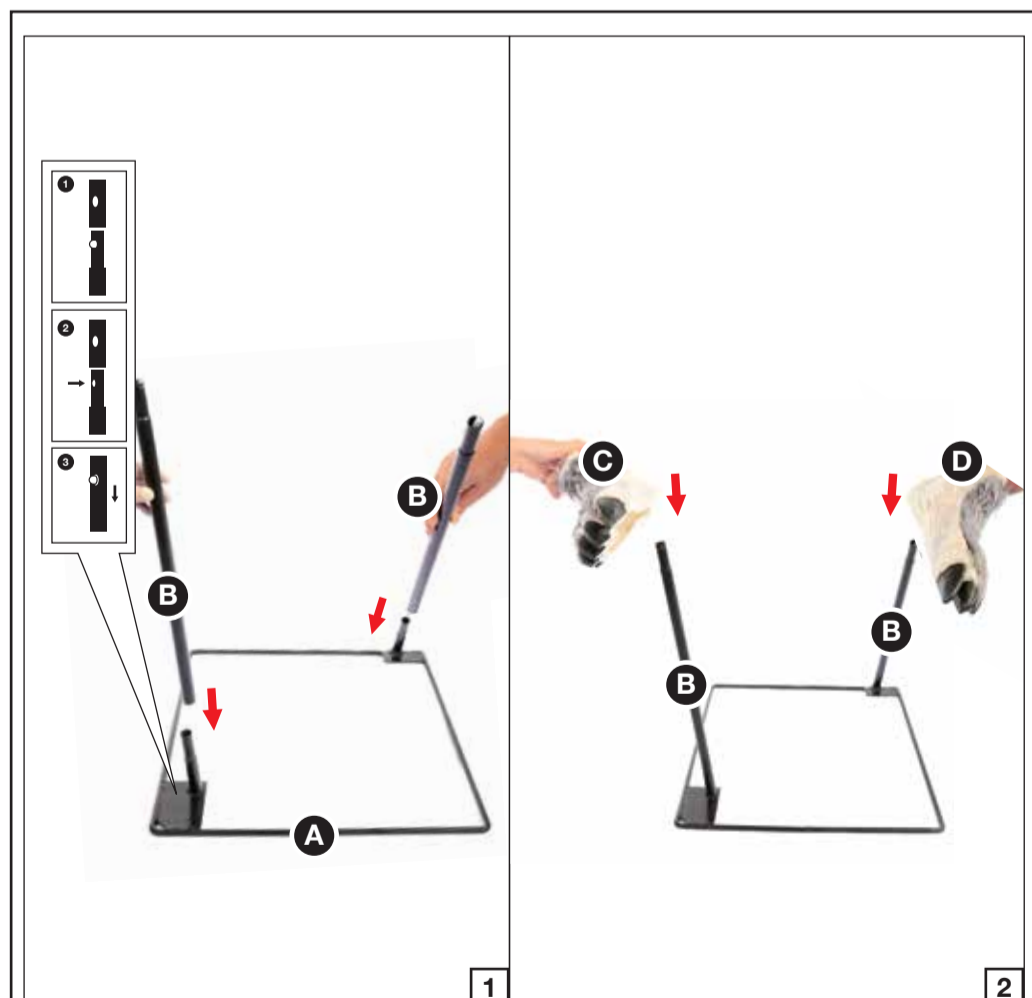

STEP1

Note: The Poles located on the (A) Base slant towards the front.
 Attach the (B) Lower Support Poles to the (A) Base as shown and secure by aligning the quick-connect push buttons into the pre-drilled holes as shown in Figure 1.
 Lower the (C) Right Foot and (D) Left Foot over the (B) Lower Support Poles as shown in Figure 2.

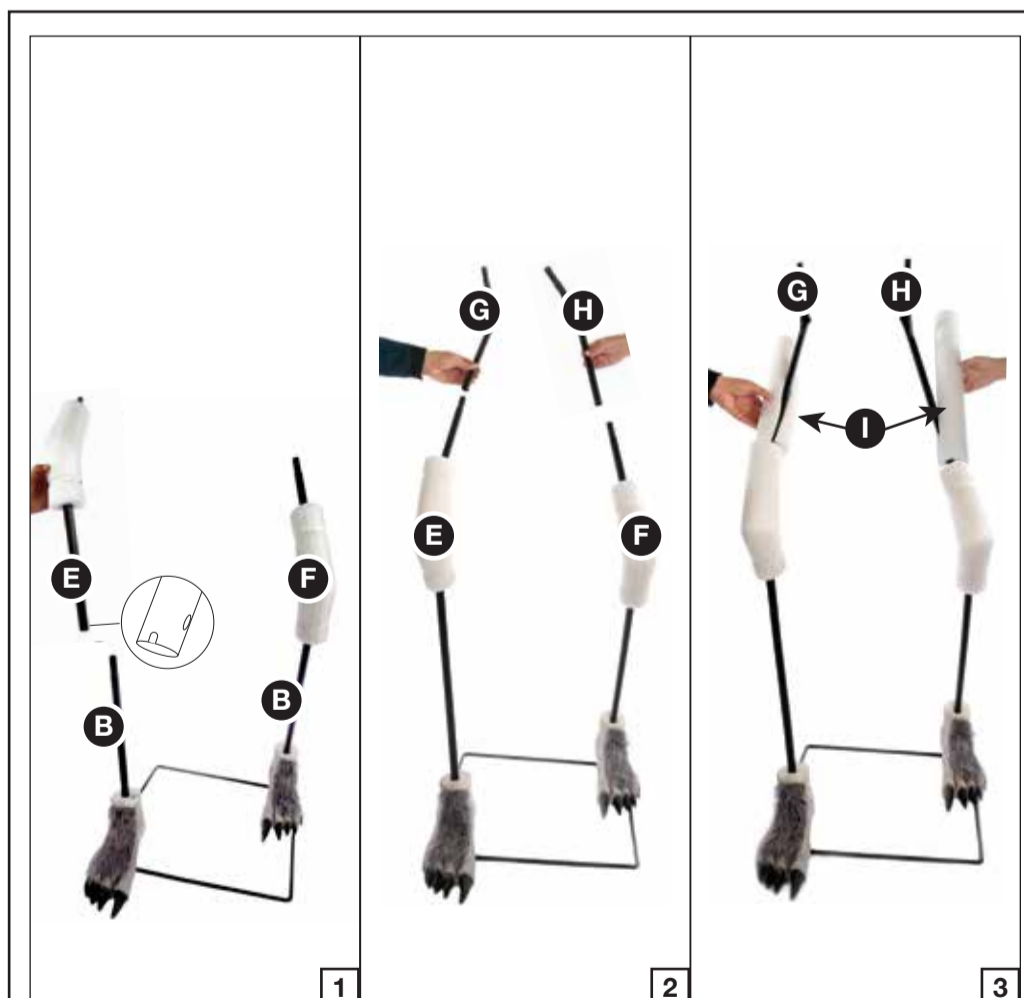

STEP2

Attach the (E) Right Middle Support Pole and the (F) Left Middle Support Pole to the (B) Lower Support Poles as shown in Figure 1 and secure by aligning the quick-connect push buttons into the pre-drilled holes.
 Assemble the (G) Right Upper Support Pole to the (E) Right Middle Support Pole and the (H) Left Upper Support Pole to the (F) Left Middle Support Pole aligning the quick-connect push buttons into the pre-drilled holes as shown in Figure 2 .
 Wrap the (G) Right Upper Support Pole and the (H) Left Upper Support Pole with the (I) Foam Tubes as shown in Figure 3.



OPTIONAL: If you choose to use the Step Here Try-Me Activation Pad, plug the connector into the input receiving jack marked "TRY ME" on the Function Control box and route the Step Here Pad down and out the bottom, then set the Step Here Pad in front of the character.

STEP3

Lower the (J) Pants over the assembled support poles as shown in Figure 1. Assemble the (K) Torso Frame to the (G) Right Upper Support Pole and the (H) Left Upper Support Pole as shown in Figure 2 and secure by aligning the quick-connect push buttons into the pre-drilled holes. Now, plug the Adapter into the input receiving jack marked "DC 5.9V" on the Function Control Box. Note: Do not plug the Adapter into power outlet until item assembly is completed.



STEP5

Attach the (O) Sensor inside of the (N) Coat with the hook & loop closures as shown in Figure 1. Set the (P) Head onto (K) Torso Frame by sliding the forked-hook into the "neck" slot housing on the (K) Torso Frame as shown in Figure 2.

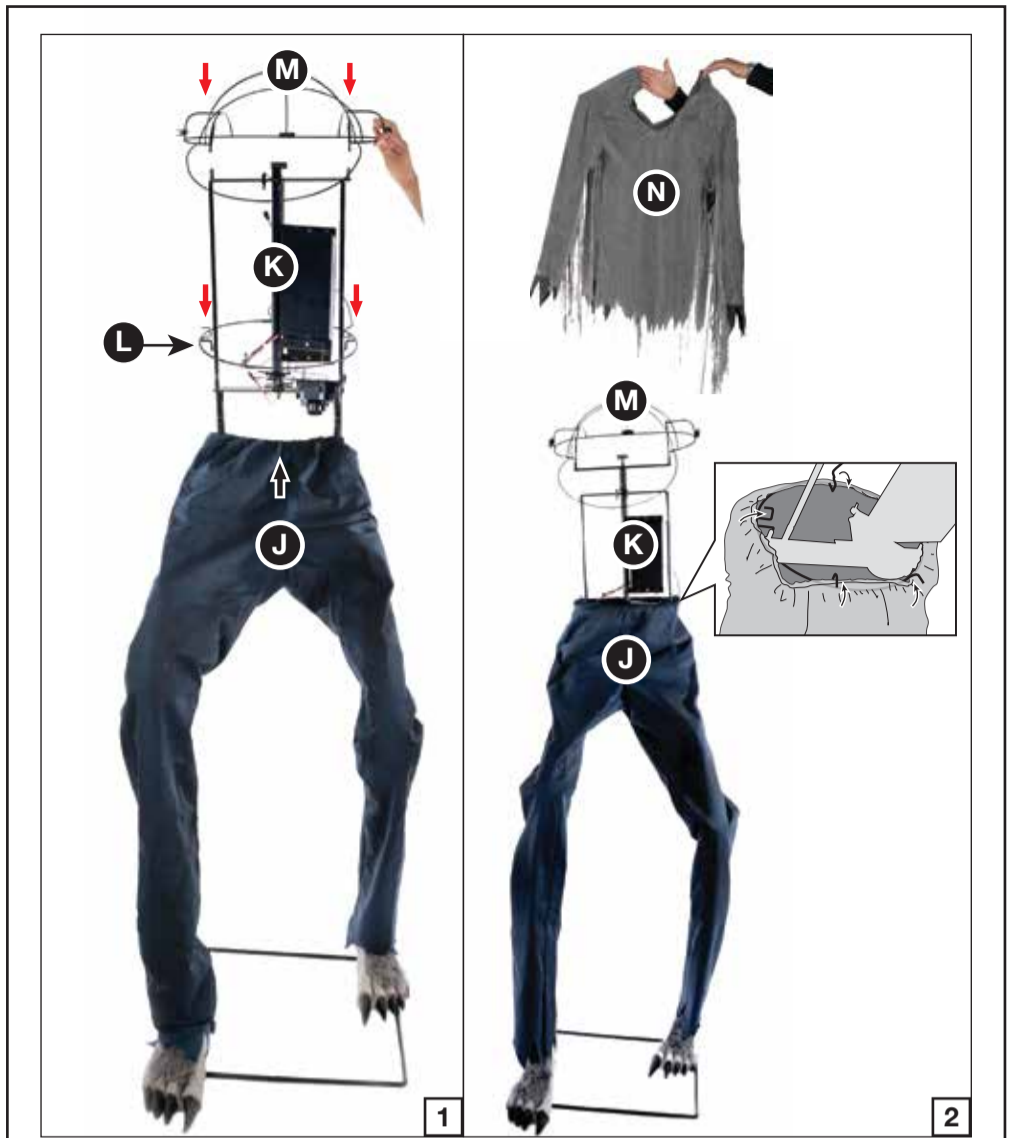

STEP4

Lower the (L) Hip Hoop down over the (K) Torso Frame and attach through the slots located on the bottom of the (K) Torso Frame as shown. Attach the (M) Shoulder Frame by sliding it into the slots located on the top of the (K) Torso Frame as shown in Figure 1. Pull the (J) Pants up over the (L) Hip Hoop. Lower the (N) Coat down over the (M) Shoulder Support and (K) Torso Frame as shown in Figure 2.

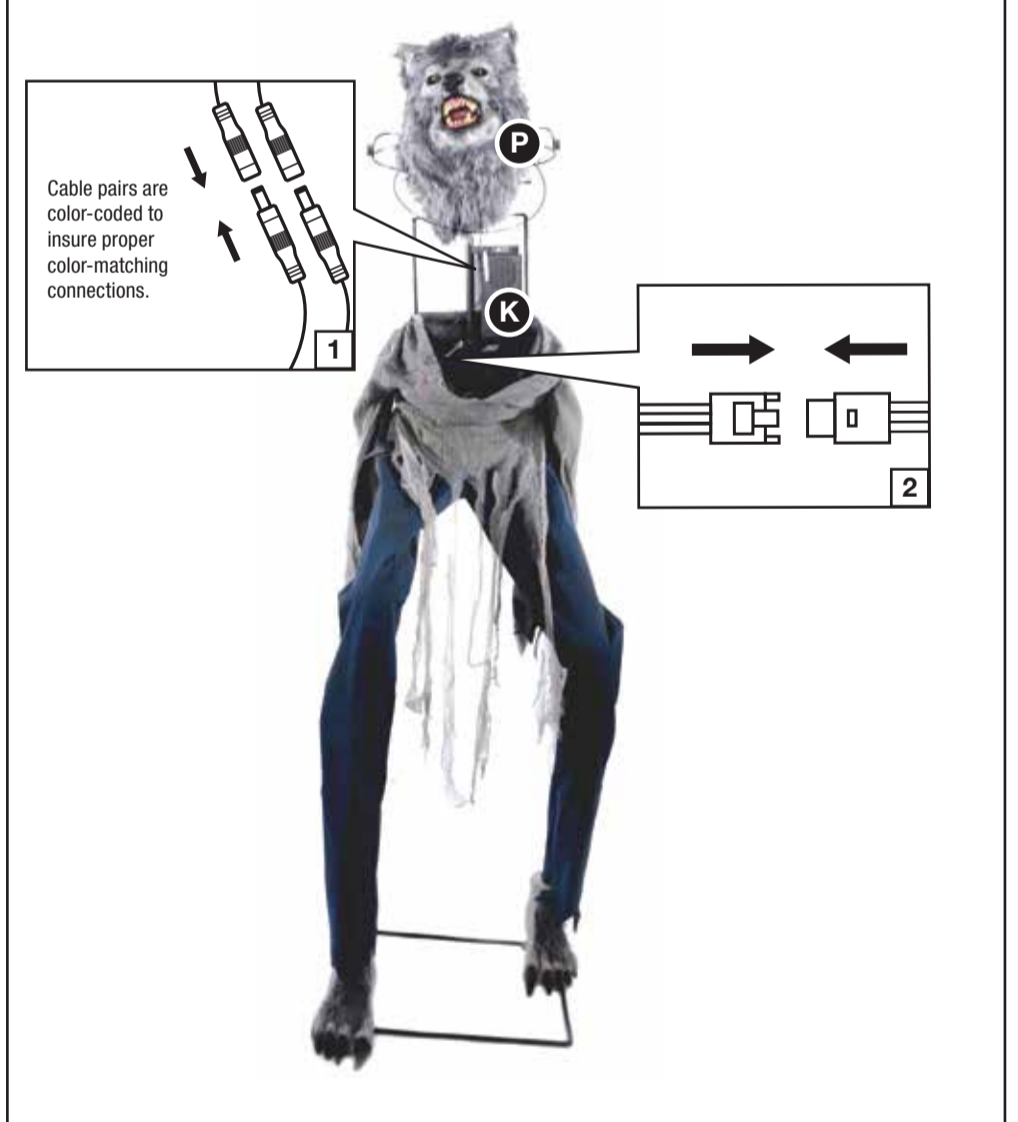

STEP6

Connect the cables from the (P) Head to the color-coordinated cables on the Function Control box located on the (K) Torso Frame as shown in Figure 1. Connect the cable from the (O) Sensor to the cable on the Function Control box on the (K) Torso Frame as shown in Figure 2.

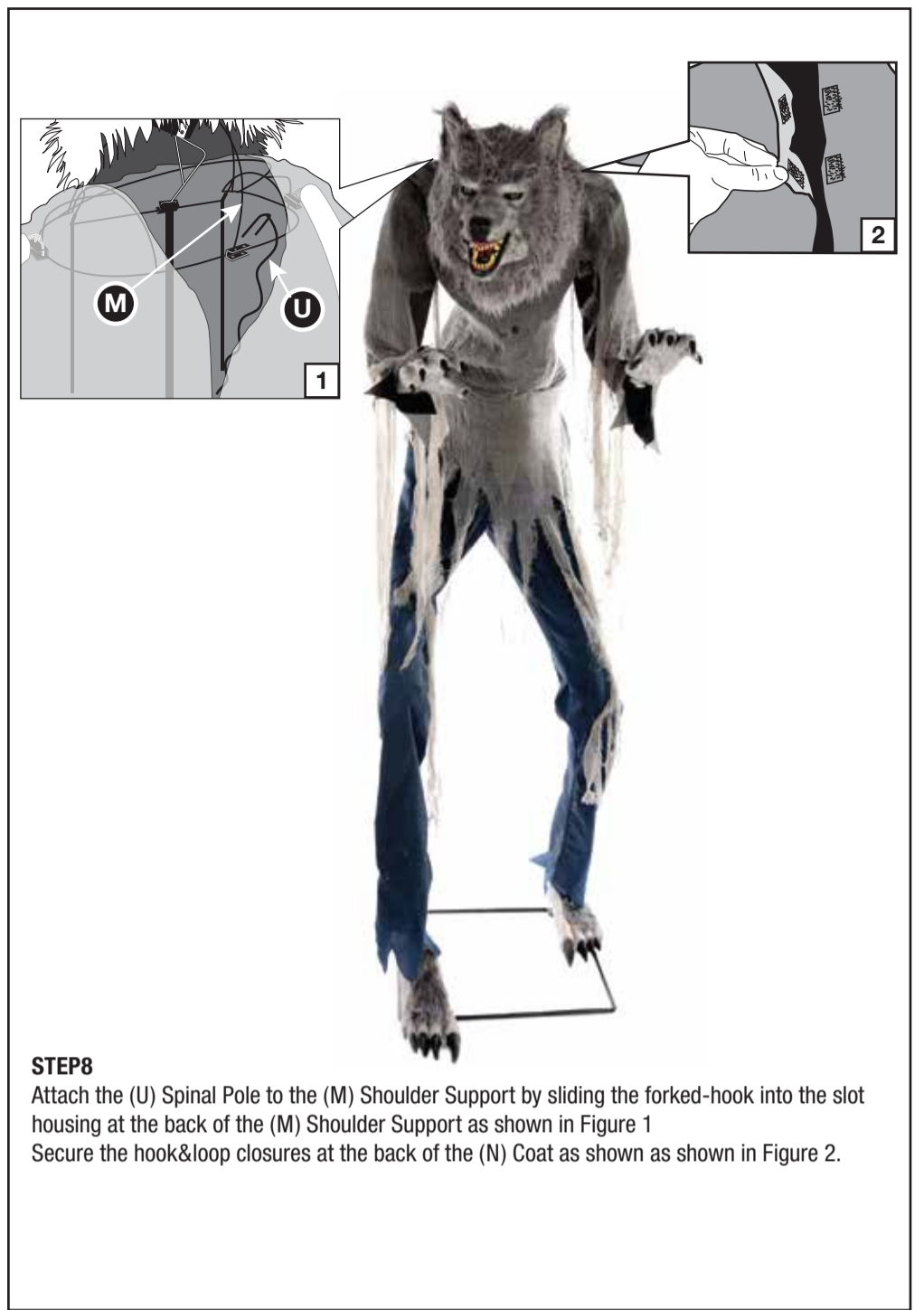
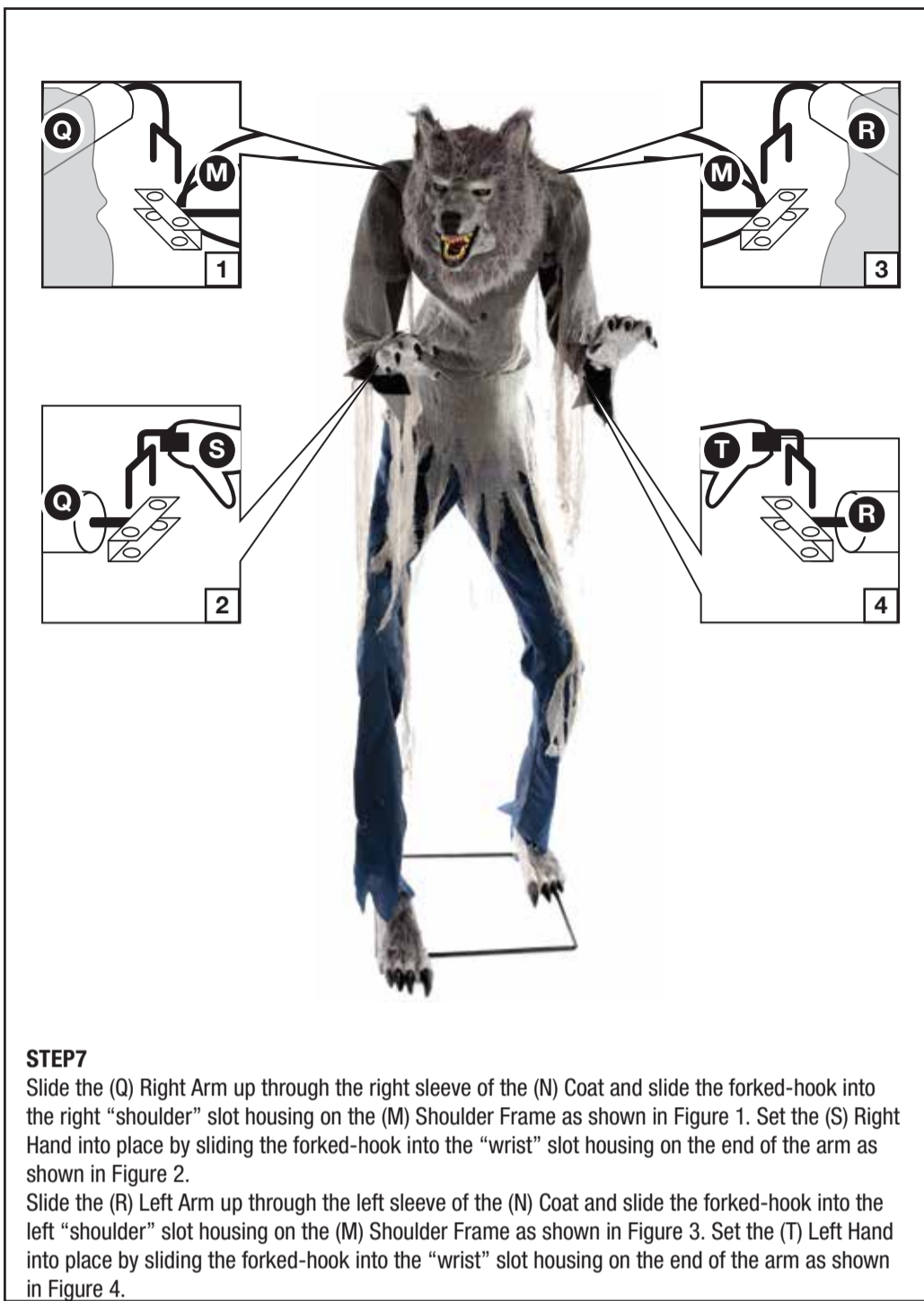

OPERATION INSTRUCTIONS:

1. Plug the AC adapter into a standard power outlet and adjust the settings on the Function Control Box, located on the (K) Torso Frame, as desired.

2. Settings:

Sensor - This switch mode will activate lights, sound, and animation when the Infra-red (IR) sensor is activated and will operate for 1 audio-cycle with each activation. The Infra-red (IR) sensor has a range of up to 2 m/6.5 ft. and will activate when someone comes within an 80-degree angle from left-to-right, as well as from above and below.

○ (OFF/Try Me) - This switch mode allows the item to be activated only if triggered by using a Step Here Try Me Activation Pad (Sold Separately). The item will operate for one audio cycle with each Try Me activation. Refer to Assembly Instructions Step3 for further details.

I (ON) - This switch mode will continually operate the lights, sound, and animation of the item.

⌚ - Raise or lower the volume using the volume control turn dial, turn and click all the way down to turn the volume off.

CAUTION: Changes or modifications not expressly approved by the party responsible for compliance could void the user’s authority to operate the equipment.

NOTE: This equipment has been tested and found to comply with the limits for a Class B digital device, pursuant to Part 15 of the FCC Rules. These limits are designed to provide reasonable protection against harmful interference in a residential installation. This equipment generates, uses and can radiate radio frequency energy and, if not installed and used in accordance with the instructions, may cause harmful interference to radio communications. However, there is no guarantee that interference will not occur in a particular installation. If this equipment does cause harmful interference to radio or television reception, which can be determined by turning the equipment off and on, the user is encouraged to try to correct the interference by one or more of the following measures: Reorient or relocate the receiving antenna, Increase the separation between the equipment and receiver, Connect the equipment into an outlet on a circuit different from that to which the receiver is connected. Consult the dealer or experienced radio/TV technician for help.

CAN ICES-3 (B)/NMB-3 (B)

